

SEE INSET
THIS SHEET
FOR
CONTINUATION

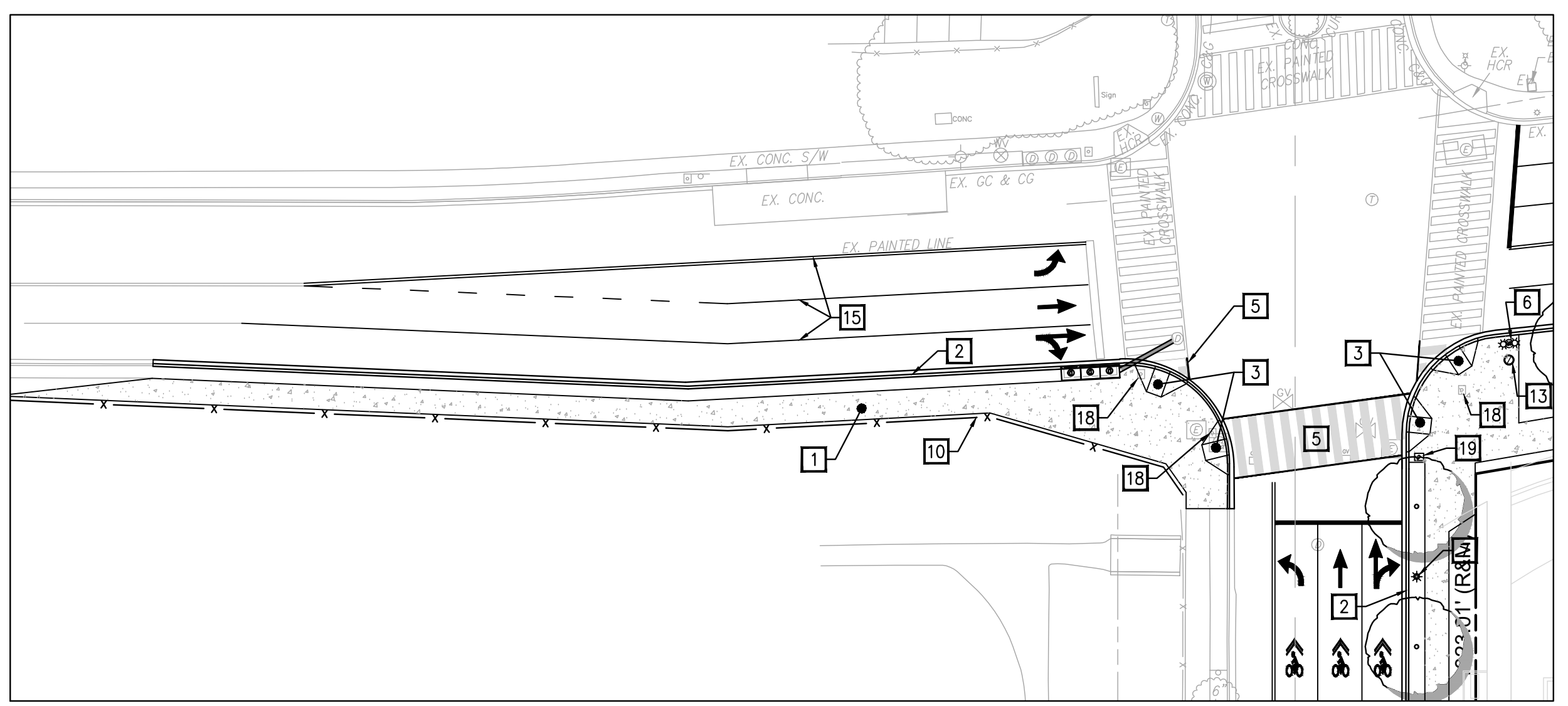

INSET "A"
SCALE: 1" = 30'

CAUTION!!
THE LOCATIONS OF ALL EXISTING UNDERGROUND UTILITIES SHOWN ON THIS PLAN ARE BASED UPON ABOVE GROUND EVIDENCE (INCLUDING, BUT NOT LIMITED TO, MANHOLES, INLETS, VALVES, AND MARKS MADE UPON THE GROUND BY OTHERS) AND ARE SPECULATIVE IN NATURE. THERE MAY ALSO BE OTHER EXISTING UNDERGROUND UTILITIES FOR WHICH THERE IS NO ABOVE GROUND EVIDENCE OR FOR WHICH NO ABOVE GROUND EVIDENCE WAS OBSERVED. THE EXACT LOCATIONS OF SAID EXISTING UNDERGROUND UTILITIES SHALL BE VERIFIED BY THE CONTRACTOR PRIOR TO ANY AND ALL CONSTRUCTION.

MISS UTILITY
CALL DC ONE CALL "DOC" AT 1-800-257-7777 48 HOURS PRIOR TO THE START OF WORK. THE EXCAVATOR MUST NOTIFY ALL PUBLIC UTILITY COMPANIES WITH UNDER GROUND FACILITIES IN THE AREA OF PROPOSED EXCAVATION AND HAVE THOSE FACILITIES LOCATED BY THE UTILITY COMPANIES PRIOR TO COMMENCING EXCAVATION. THE EXCAVATOR IS RESPONSIBLE FOR COMPLIANCE WITH REQUIREMENTS OF THE DISTRICT OF COLUMBIA CODES AND REGULATIONS.

TREE PLANTING NOTE:

PRIOR TO PLANTING ANY STREET TREE, A WALK-THROUGH MUST BE SCHEDULED WITH URBAN FORESTRY AND THE WARD ARBORIST TO CONFIRM TREE SPECIES SELECTIONS AND TO ENSURE AVOIDANCE OF A MONOCULTURE WHEN SELECTING / PLANTING SAID SPECIES.

CONTACT JABBARI BREW WARD ARBORIST:
JABBARI.BREW@DC.GOV
202-438-7949

LEGEND:

NEW CONCRETE

TREE PLANTING SCHEDULE

TREES	QT Y.	BOTANICAL NAME	COMMON NAME	NATIVE
	10	Quercus palustris Specimen, B&B	Red Maple	Yes
	10	Ilex verticillata 'Jim Dandy'	Japanese Zelcova	Yes
	10	Ilex verticillata 'Red Sprite'	London Plane Tree	Yes

SITE KEYNOTES:

- 1 NEW CONCRETE SIDEWALK IN PUBLIC SPACE. REFER TO DDOT DETAIL 605.01 ON SHEET PS-CIV0531.
- 2 NEW GRANITE CURB AND BRICK CUTTER IN PUBLIC SPACE. REFER TO DDOT DETAILS 606.02 AND 606.04 ON SHEET PS-CIV0531.
- 3 NEW CONCRETE ADA RAMP IN PUBLIC SPACE. REFER TO DDOT DETAIL 606.08 ON SHEET PS-CIV0531.
- 4 NEW STANDARD DDOT U BICYCLE RACK. SEE BICYCLE RACK DESIGN DETAIL ON SHEET PS-CIV0531 FOR DETAILS.
- 5 NEW PAINTED CROSSWALK.
- 6 NEW TWIN 20 STANDARD DDOT LIGHTPOLE IN PUBLIC SPACE. REFER TO DDOT DETAILS 614.11 AND 614.12 ON SHEET PS-CIV0531. SEE STREETLIGHT SET FOR ADDITIONAL INFORMATION.
- 7 NEW SINGLE #16 STANDARD DDOT LIGHTPOLE IN PUBLIC SPACE. REFER TO DDOT DETAIL 614.11 ON SHEET PS-CIV0531. SEE STREETLIGHT SET FOR ADDITIONAL INFORMATION.
- 8 NEW STREET TREE IN PUBLIC SPACE. SEE TREE PLANTING SCHEDULE ON THIS SHEET. REFER TO DDOT DETAIL 608.02 ON SHEET PS-CIV0531.
- 9 NEW TRAFFIC SIGNAL. COORDINATE REQUIREMENTS WITH DC TRAFFIC DIVISION.
- 10 NEW CHAIN LINK FENCE TO MATCH EXISTING.
- 11 NEW WMATA BUS SHELTER. COORDINATE REQUIREMENTS WITH WMATA.
- 12 NEW WMATA BUS STOP SIGN. COORDINATE REQUIREMENTS WITH WMATA.
- 13 NEW DDOT APPROVED TRASH RECEPTACLE. SEE DETAIL ON SHEET PS-CIV0532 FOR DETAILS.
- 14 NEW DDOT APPROVED BENCH. SEE DETAIL ON SHEET PS-CIV0532 FOR DETAILS.
- 15 NEW PAVEMENT STRIPING PER DDOT STANDARDS AND SPECIFICATIONS.

- 16 NEW CONCRETE CURB. REFER TO DDOT STANDARD DETAIL 606.01 ON SHEET PS-CIV0532 FOR DETAILS.
- 17 NEW CURB CUT WITH CURB RETURNS TYPE "A." REFER TO DDOT DETAIL 504.01 ON SHEET PS-CIV0533.
- 18 EXISTING TRAFFIC SIGNAL TO REMAIN AND BE PROTECTED DURING CONSTRUCTION PER DDOT STANDARDS AND SPECIFICATIONS.
- 19 EXISTING TRAFFIC SIGNAL TO BE RELOCATED. REFER TO TRAFFIC SIGNAL PLANS FOR DETAILS (DESIGN BY OTHERS).



MCMILLAN
SITE DEVELOPMENT
PACKAGE
LOT 800; SQUARE 3128
WASHINGTON, DC

OWNER
DISTRICT OF COLUMBIA
Office of the Deputy Mayor for
Planning & Economic Development
1350 Pennsylvania Ave. NW
Washington, DC 20004
Tel. (202) 727-6365

DEVELOPER
VISION MCMILLAN PARTNERS
1508 U Street NW
Washington, DC 20009
Tel. (202) 462-1092

Bowman
CONSULTING DC
888 17th Street NW, Suite 510
Washington, DC 20006
Phone: (202) 750-2474
www.bowmanconsultingdc.com
© Bowman Consulting Group, Ltd.

**PUBLIC SPACE
PACKAGE
ISSUED FOR
CONSTRUCTION
KEY PLAN**

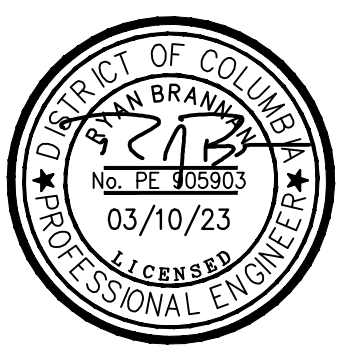
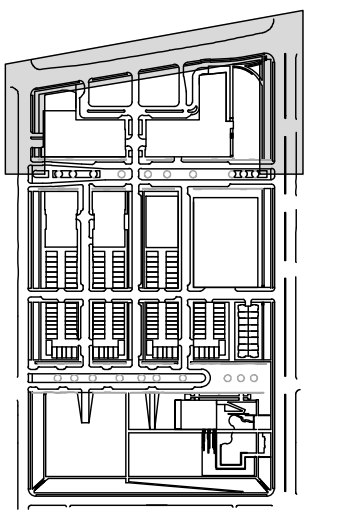

I AM RESPONSIBLE FOR DETERMINING THAT THE ENGINEERING DESIGNS INCLUDED IN THIS APPLICATION ARE IN COMPLIANCE WITH ALL LAWS AND REGULATIONS OF THE DISTRICT OF COLUMBIA. I HAVE PERSONALLY PREPARED, OR DIRECTLY SUPERVISED THE DEVELOPMENT OF THE ENGINEERING DESIGNS INCLUDED IN THIS APPLICATION.

NO.	DATE	DESCRIPTION
1	03/04/21	PERMIT SET REVISIONS
2	04/04/23	ISSUED FOR CONSTRUCTION

ASF DESIGN	ASF DRAWN	RJB CHKD

JOB No. 116266-02-006
DATE MAR., 2023

**PUBLIC SPACE -
SITE PLAN**
SHEET **PS-CIV0141**